

REUNION 2022

WEEKEND SCHEDULE

JUNE 2-5



Grinnell College

DEAR GRINNELLIANS:

On behalf of the entire Grinnell College community, welcome to the 142nd Reunion Weekend!

Reunion brings together alumni and friends from all over the country, and even the world, to participate in events, discussions, seminars, entertainment, and celebrations of the people, places, and principles that make us uniquely Grinnell.

This weekend is the result of months of work by many in the Grinnell College community: alumni volunteers, staff members, faculty, and students. We especially want to express a deep sense of appreciation for our dedicated Reunion planning committees, who have worked diligently over the past year with the goals of providing you with this opportunity to reconnect with old friends and experience firsthand the Grinnell campus and community.

By returning to Grinnell for this milestone weekend, you are demonstrating your commitment to our Grinnell community. Active alumni are an essential part of Grinnell, and your involvement and dedication helps to connect students of today to a rich history and a proud tradition of excellence. We greatly value your desire to help sustain and enhance Grinnell College for each other and for all our students.

Thank you again for your continuing interest, enthusiasm, and devotion to Grinnell. We are honored to welcome you home this weekend.

Jayn Bailey Chaney '05

Director of Alumni and Donor Relations

TABLE OF CONTENTS

- 4** COVID-19 Safety and Responsibility
- 5** The Reunion App and Internet Access
- 6** Local Shuttle and Golf Cart Information
- 7** Reunion Weekend Schedule
- 14** Campus Map
- 22** General Information
- 23** Open Hours
- 24** Art Exhibitions
- 25** Celebrating our 2022 Reunion Class Volunteers

REGISTRATION DESK, HELP DESK, AND INFORMATION

Joe Rosenfield '25 Center (JRC), Lobby

Thursday 8 a.m.–11 p.m.

Friday 8 a.m.–11 p.m.

Saturday 8 a.m.–11 p.m.

Sunday 8 a.m.–1:30 p.m.

Upon check-in, please keep the envelope that your room key(s) and P-card are provided in. Upon check-out on Sunday, please return your key(s) and P-card in the same envelope to the registration desk before you leave campus. If you leave campus before the registration desk opens, please leave them in your dorm room.

The Reunion help desk is "Reunion Central" on campus and can assist you with all non-emergency matters. (641-269-3223)

NAME BADGES

Please be sure to wear your name badge at all times, as it is your entrance pass to all events and indicates to staff, students, and campus safety that you are attending Reunion.

If we have spelled your name wrong or you would like something changed on your name badge, please stop by the help desk. We are happy to make the change for you so you can more fully connect with classmates, students, faculty and staff, and other Grinnellians.

COVID-19 SAFETY AND RESPONSIBILITY

As of Tuesday, May 31, Grinnell College will shift to a modified green activity level. As a result, masks will be optional at Grinnell College during Reunion, except in the following situations:

- If experiencing COVID-19 symptoms
- If you have recently tested positive and are returning to campus following 5 full days of isolation (5 days of isolation + 5 days of masking).

Masks are recommended for:

- People who have a known exposure* to a COVID positive individual
- People who are high risk
- Alumni and their guests to campus from areas/regions of high transmission.

While masks on campus are not required, anyone may choose to wear one at any time based on individual preference, perspective, and circumstance. As Grinnellians, please be mindful and respectful of other attendees' choices.

Given the number of individuals traveling to Grinnell from around the world, we strongly encourage participants who choose to mask to wear high quality masks (KN95, N95, or surgical masks, not cloth masks). A supply of these high-quality masks will be available for you during Reunion at the registration desk.

Visit alumni.grinnell.edu/events/reunion/reunion-covid-safety-and-responsibility for a full overview of COVID-19 safety protocols and community resources.

If any time during Reunion, you feel unwell:

1. Please wear a mask and do not attend Reunion events. If you need a new mask, you can pick one up at the registration desk.
2. Test yourself. A limited supply of COVID-19 rapid test kits are available at the JRC registration desk. You can also purchase a rapid test at a local store or pharmacy; a local shuttle is available from 4 to 10 p.m. daily with stops at Walmart and Hy-Vee, among other locations. Masks are required on the local shuttle.

Have you tested positive for COVID-19 and need to isolate while you are on campus? Contact Jackie Aanes at 641-269-3216 or aaanesjac@grinnell.edu between 8 a.m. and 10 p.m.

* *Exposed/Exposure = within 6 feet or less of a confirmed positive for 15 or more minutes cumulative within a 24-hour period and both individuals are unmasked.*

HAVING A MEDICAL EMERGENCY? CALL 911.

LOCAL MEDICAL SERVICES

UnityPoint Health, 202 Fourth Ave.

Emergency Room open 24/7

Manatt Walk-in Clinic, 8 a.m.–7 p.m. M–F, 8 a.m.–2 p.m. Saturday

Walk-in clinic phone: 641-236-2323

QuickVisit Urgent Care, 213 West St. South

7 a.m.–7 p.m. M–F, 8 a.m.–6 p.m. Saturday, 1–5 p.m. Sunday

641-519-0563

GET THE REUNION APP!

Get the mobile app for an interactive schedule! To navigate within the app, please click on the library in the upper left-hand corner.

From your smartphone:

1. Open either your app store or Google Play Store on your smart device. Search for "Guidebook."
2. Download the app.
3. Once downloaded, open the app and search for the guide Grinnell Reunion 2022.

From a computer or tablet:

1. Go to <http://alumni.grinnell.edu/reunionapp>. The link will redirect you to the appropriate page on your device. If you're on iOS, it will display a link to the Apple App Store. If you're on an Android, you will receive a link to the Google Play Store. If you're on a PC, you will receive a prompt to have a link sent to your phone by text or to go to the web versions of the app stores.
2. Download the app.
3. Once downloaded, open the app and click on Grinnell Reunion 2022.

Once you download the app, we encourage you to create an account. This will allow you to access a list of attendees, send them messages, customize your schedule, and receive notifications of rain calls or other changes in the schedule.

INTERNET USE

Grinnell College provides free wireless access to guests visiting campus through a self-registration system. Please select the wireless network **GrinnellCollegeGuests**; no verification is necessary.

If you have any questions, please email helpdesk@grinnell.edu, stop by the South Forum office, or call 641-269-4901, 8 a.m.–4:30 p.m. Monday through Friday.

BE SOCIAL

Grinnell College and the Office of Development and Alumni Relations want to connect with you during Reunion. You can find us via these online social networks:

Facebook.com/grinnellcollegealumni
Twitter.com/grinnellcollege
Instagram.com/grinnellcollege
Instagram.com/grinnellcollegealumni

LOCAL SHUTTLES AND GOLF CARTS

Shuttle and golf cart service is available throughout Reunion weekend during the following hours:

- 11 a.m.–11 p.m. Thursday, June 2
- 8 a.m.–11 p.m. Friday, June 3, and Saturday, June 4
- 8 a.m.–1:30 p.m. Sunday, June 5

To request golf cart transportation or shuttle service to/from the local motels and hotels, please call **641-269-4403** during these hours to arrange for a pickup.

In addition, shuttle service is available for birding tours, CERA tours, and all 60th and 55th Reunion off-campus Reunion events. See the event schedule for shuttle departure locations.

THE GRINNELL COLLEGE LOCAL SHUTTLE

Grinnell College also operates a local shuttle van that makes stops at a variety of shopping and care destinations around Grinnell (McNally's, Hy-Vee, Walmart, Urgent Care, and downtown Grinnell).

- Runs from 4–10 p.m. daily, Wednesday, June 1, through Saturday, June 4.
- Leaves from the front of the Noyce Science Center on the hour each hour.
- Free to ride but you need your Reunion badge as your ticket.
- Riders missing the last shuttle of the evening will be responsible for finding their own way back to campus

Visit www.grinnell.edu/campus-life/transportation/local for more information and a detailed schedule for this local shuttle.

REUNION 2022 SCHEDULE

THURSDAY, JUNE 2

2–3 p.m.

Grinnell College Campus Tour

Departs from the Joe Rosenfield '25 Center (JRC), mailroom

2–5 p.m.

Crowdsourcing Photos

JRC, lobby

Help the Burling Library Special Collections and Archives staff identify photographs from your time at Grinnell. Staff from the Special Collections and Archives will host a table in the JRC lobby, asking alumni to help identify people, places, and events found in our photograph collection. We will have photos available from every class or cluster at Reunion, so please stop by and lend a hand!

3–6 p.m.

Grinnell Farmers Market

Central Park, Fourth Avenue and Broad Street

This market is a 100% producer's market; all vendors must sell products that they produce themselves.

4–5 p.m.

Tour the new Humanities and Social Studies Center (HSSC)

HSSC, Kington Plaza

5–7 p.m.

Pioneer Bookshop Open House: Featuring Grinnellian Authors

Pioneer Bookshop, 933 Main St. The Grinnell College Bookshop is downtown! Stop by to meet some of the many Grinnellians who have published books.

6–8 p.m.

55th Reunion Welcome

Grinnell Golf Course, banquet room and lounge, 933 13th Ave. Members of the classes of 1965 and 1966 are invited to this informal event as we kick off our weekend of reconnecting. A cash bar will be available. A shuttle is available to the golf course from the JRC starting at 6 p.m.

6:30–8 p.m.

Multicultural Reception

HSSC, International Lounge Build community with alumni who are BIPOC, LGBTQIA+, from various religious affiliations, members of the disability community, first generation, or international students. We will eat delicious food, share amazing stories, laugh too much, and get to know some of the staff members from Intercultural Affairs; Accessibility and Disability Resources; the Center for Religion, Spirituality, and Social Justice; and the Office of International Student Affairs.

7 p.m.

Music in the Park Featuring Lincoln Highway

Central Park Band Shell, Fourth Avenue and Broad Street
Bring a bag chair or a blanket to enjoy live music in the newly renovated Central Park. This pop-country trio from Altoona, Iowa, will include some Grinnell locals. Their music will give you all the nostalgic feels of celebrating your Reunion in a small town on a summer evening. Sponsored by Grinnell College Office of Development and Alumni Relations and presented by the Grinnell Area Arts Council as part of its summer Music in the Park series.

7–9 p.m.

35th Reunion Cluster Welcome

Loose Hall, tent
Members of the classes of 1986, 1987, and 1988 are invited to an informal gathering outside Loose Hall. Join us to kick off our Reunion weekend, reconnect with classmates, and inaugurate the cluster's ChairFarm. Bring yourself, beverage of your choice, and a bag chair (or two), then watch the ChairFarm grow!

7–10 p.m.

50th Reunion Welcome

The Periodic Table and Ballroom, Hotel Grinnell, 925 Park St.
Members of the classes of 1970, 1971, and 1972 are invited to join classmates and friends for a casual and fun evening to kick off the 50th reunion weekend. A cash bar will be available (credit cards accepted).

7–10 p.m.

25th Reunion Welcome

Solera Wine Bar, 829 Broad St.
Members of the class of 1997 are invited to an informal gathering at the fabulous Solera Wine Bar. Please join your Reunion Planning Committee at this no-host event as we kick off our weekend of reconnecting.

8–10 p.m.

Still Fabulous at 45: 45th Reunion Cluster Happy Hour

Yunker Hall, lounge
Come sample "John's Pub" at this casual welcome event for the classes of 1975, 1976, and 1977.

9–11 p.m.

Alumni Happy Hour and Grinnell Pub Quiz

Grinnell Craft Brewhouse, 923 Main St.
Head on over to the Brewhouse on Main Street in downtown Grinnell. Enjoy a craft beer and grab a snack while competing in a Grinnell-themed pub quiz! **Pub Quiz will begin promptly at 9 p.m.** so get there early and form a team with a clever name. Late arrivals are welcome to watch, but will not be able to join the competition.

9:30 p.m.

Rocky Horror Picture Show

Central Campus, Commencement Stage
Time Warp is more than Reunion. Costumes are encouraged, and virgins are welcome — just come! Chair or blanket suggested. Props provided to the first 50 attendees! Sponsored by the classes of 1986, 1987, and 1988.

FRIDAY, JUNE 3

6–9:30 a.m.

Birding Excursion

Departs from the southeast entrance of the JRC
Hosted and led by **Jeri Langham '65**, tour leader for Victor Emanuel Nature Tours, offering birding excursions worldwide, with assistance from **Dave Cameron '86**. Bring your binoculars (a limited number will be available to borrow). Space is limited. Please sign up at the Reunion registration area. Sponsored by the classes of 1965 and 1966.

7:30–9 a.m.

Breakfast in the Marketplace

(first meal served for Reunion)
JRC, Marketplace

8–10:30 a.m.

Trip to Conard Environmental Research Area (CERA)

Departs from front of JRC
Join faculty from the Department of Biology in touring the College's biological field station. The one-mile hike will take you through reconstructed prairie, restored savanna, along Willow Creek and Perry Pond, and through two experimental plot arrays, ending with a brief tour of the Environmental Education Center.

8:30–9:30 a.m.

Open AA/Al-Anon Recovery Meeting

Goodnow, Room 109
Alumni, their families, staff, and students are welcome to attend.

8:30–10 a.m.

Welcome Grilled Bagels

Outside the JRC
The 35th Reunion Cluster welcomes fellow alumni to campus with grilled bagels — "Forum style!" If raining, this will be in the JRC in the second-floor lobby area. Sponsored by the classes of 1986, 1987, and 1988.

8:30–10 a.m.

25th Reunion Breakfast

Main Hall, Quad Dining Hall
The class of 1997 celebrates its 25th Reunion with a special welcome breakfast featuring honored guests and familiar faces. There will be a short program at 9:30 a.m.

8:30–10 a.m.

BRAG (Bike Ride Around Grinnell)

Meet at Bikes to You, 921 Broad St.
In this guided ride, you will get a chance to get some exercise while exploring Grinnell and the Iowa countryside. The group will bike approximately 10 miles on paved roads while Craig Cooper, owner of Bikes to You and past Grinnell Chamber of Commerce president, shares interesting historical and community information. Helmets are required; both helmets and bikes are available for rent. Call or email Bikes to You at 641-236-8600 or craig@bikestoyou.com for rental information (limited number of bikes available).

9 a.m.–noon

Conney M. Kimbo Black Cultural Center (BCC) Open House

Conney M. Kimbo Black Cultural Center (BCC), 1000 10th Ave.

Buzzing with social, cultural, and academic activities, the BCC preserves and celebrates Black history, culture, and diasporas of people who identify with African heritage. Stop by, visit the space, and talk to some current students involved in the BCC.

9 a.m.–noon

Stew Makerspace Open House

Stew Makerspace, 927 Broad St.

Join **Craig Gibbens '95**, program and education coordinator, for an open house at the Stew Makerspace to learn about its role as a creative, multipurpose space in downtown Grinnell, and make buttons to celebrate Reunion 2022. The effort is a collaboration between the Grinnell Area Arts Council and the Wilson Center at Grinnell College. It serves as a free space for fabrication, tinkering, and more for community members, students, and faculty.

9:30–11 a.m.

Preparing for Life After Grinnell: The Center for Careers, Life, and Service (CLS)

JRC, Room 101

Join leaders from CLS to learn more about their work supporting students and how alumni volunteers are making a difference in our students' postgraduate exploration. Sponsored by the classes of 1965 and 1966.

50th Reunion Class Photos

Charles Benson Bear '39 Recreation and Athletic Center (Bear), Darby Gym

10:30 a.m. — 1970

10:50 a.m. — 1971

11:10 a.m. — 1972

10:30–11:30 a.m.

Grinnell College Campus Tour

Departs from JRC, mailroom

10:30–11:30 a.m.

A Calming Hour: Yoga Nidra/Yin Yoga with Jane Davidson '87

Bucksbaum Arts Center, Room 181 (Batts Dance Studio)

Take a break from the outside world and turn inward for an hour of yin and yoga nidra with **Jane Davidson '87**, certified RYT 200 yoga teacher. This class begins with yin yoga, a gentle practice consisting of comfortable sustained poses, held for three to five minutes. Longer holds open and nourish the connective tissue and allow the mind to quiet. You will then be led through yoga nidra, a form of guided meditation in a supine position designed to support the release of tension so you can achieve both a state of deep relaxation and heightened mental awareness. Comfortable, loose-fitting clothing is recommended. You may want to bring an extra layer for warmth during yoga nidra. Sponsored by the classes of 1986, 1987, and 1988.

10:30–11:45 a.m.

The Political Economy of Polarization in America, with a Few Ideas on Reversing It

HSSC, S1325 (presentation room)

This talk and discussion with **Bill Ferguson '75**, Gertrude B.

Austin Professor of Economics, will address underlying political and economic conditions that have led to increasing polarization in the United States over the past 50 years, culminating in controversies over guns, immigration, COVID-19, and teaching about race. Concluding ideas on a reversal with draw from Professor Ferguson's prior experience as a community organizer. Sponsored by the classes of 1975, 1976, and 1977.

11:30 a.m.–12:45 p.m.

50th Reunion Luncheon

Harris Center, concert hall

A special celebratory luncheon for the classes of 1970, 1971, and 1972.

11:30 a.m.–1:30 p.m.

Lunch in the Marketplace

JRC, Marketplace

Noon–1:15 p.m.

60th Reunion Luncheon

HSSC, A1231 (Multipurpose Room)

A celebratory luncheon for the classes of 1961 and 1962.

1–2:30 p.m.

Center for Religion, Spirituality, and Social Justice (CRSSJ) Open House

CRSSJ, 913 Eighth Ave.

Stop by the center to take a tour of the space. See the lending library, the food pantry, Muslim and Hindu prayer and cultural rooms, and meditation spaces, and enjoy a beverage in our comfy chairs.

1–3 p.m.

Golf Scramble

Grinnell College Golf Course, 933 13th Ave.

Preregistration required. In the case of inclement weather, this event will be canceled.

2–3:30 p.m.

Did All Those Amazing Musicians REALLY Perform at Grinnell?

JRC, Room 101

Yes! And there were more than you probably realized or remember. How did a small school in the middle of nowhere manage to land all that talent? Join us for a panel discussion with three of our classmates who deserve a lot of the credit: **Gary Giddins '70**, **Ron Stanford '71**, and **Peter Keepnews '72**. They will explain how we consistently pulled it off, and recount stories you never heard from behind the scenes. Sponsored by the classes of 1970, 1971, and 1972.

2–4 p.m.

Beer Tasting

Mac Field, tent

The classes of 2000, 2001, and 2002 are invited to gather, mingle, and sample beers from Half Acre Beer Company (Chicago) and City Star Brewing (Berthard, Colorado) poured by **Emily Cripe '01** and **Jeff Zdunek '01**.

2–5 p.m.

Humanities and Social Studies Center (HSSC) Open House

HSSC

Stop by and take a self-guided tour of the newest building on campus. Faculty and staff members will be on hand to share details about the building, highlight the many new and innovative ways the space is being used, and share stories on how this world-class facility came to be.

2–5 p.m.

Crowdsourcing Photos

JRC, lobby

Help the Burling Library Special Collections and Archives staff identify photographs from your time at Grinnell. Staff from the Special Collections and Archives will host a table in the JRC lobby, asking alumni to help identify people, places, and events found in our photograph collection. We will have photos available from every class or cluster at Reunion, so please stop by and lend a hand!

2:30–4:30 p.m.

Downtown Walking Tour by Leading Merchants, Developers, and College Staff

Meet outside the west entrance of the JRC

Learn about the College's expansion into the Central Business District while enjoying a tasting tour of downtown's coffee houses, bakeries, brewhouses, wine bars, eateries, and restaurants. Attendees will also visit arts district studios, specialty shops, the College downtown bookshop, loft apartments, and a boutique hotel. Hosted by **Dick Knapp '76** and Grinnell College staff. Sponsored by the classes of 1975, 1976, and 1977.

3–4:30 p.m.

Pioneer Athletics Reception with Coaches

Grinnell College Golf Course, lounge and patio

Join the athletics staff, current coaches, and former coaches for a reception honoring Grinnell athletics. There will be a short program. Preregistration is encouraged.

3:30–4:30 p.m.

Gamelaners Across the Generations

Bucksbaum, Room 101 (Cornell World Music Room)

If you participated in the Gamelan Ensemble while a student at Grinnell, you are invited to stop by the Bucksbaum (formerly Fine Arts) World Music Room for an hour of nostalgia. The gamelan will be set up and ready to help resurrect the

old vibe. Professor Roger Vetter (yes, he's still around!) will have notations ready to help bring alive some old favorites.

3:30–4:30 p.m.

Grinnell College Campus Tour

Departs from JRC, mailroom

4–5:30 p.m.

LGBTQIA Alumni Reception

Yunker Hall, Stonewall Resource Center (SRC)

Join current students and alumni from Grinnell LGBTQIA and allies community for this casual reception.

4:30–5:30 p.m.

Open AA/Al-Anon Recovery Meeting

Goodnow, Room 109

Alumni, their families, staff, and students are welcome to attend.

5–5:30 p.m.

A Moment of Remembrance

Loose Hall, tent

Members of the 35th Reunion cluster are invited to meet at the tent in front of Loose Hall for a brief memorial to remember our classmates who have passed.

5–8 p.m.

Reunion Block Party

Eighth Avenue and Central Campus

Join fellow Reunion attendees for a fun evening of live music, yard games, and food trucks. There also will be a beer and wine tent. Wristbands will be required for this event, and each guest will have wristband tabs to exchange for food and beverages from our diverse array of local vendors.

On your wristband, you should have four tear-off tabs.

#1 — Main dish

#2 — Side dish

#3 — Dessert

#4 — Take-home treat for later!

There are specific meals designated for children's meals.

In order to keep lines manageable, we ask that you wait to come to the food trucks until the times stated below. Please feel free to grab a beverage from the beer tent (nonalcoholic drinks are available, as well) and enjoy the games and other activities offered until your time comes up.

5 p.m. — classes of 1970, 1971, and 1972

5:15 p.m. — families with children

5:30 p.m. — classes of 1975, 1976, and 1977

5:45 p.m. — all others

** In case of rain, the carnival portion of Block Party will be canceled. Food will still be provided by the food trucks, but inside eating areas will be in the JRC, and classes will be more staggered. Signs will be posted if this becomes necessary.*

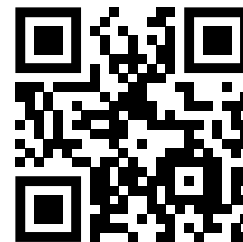
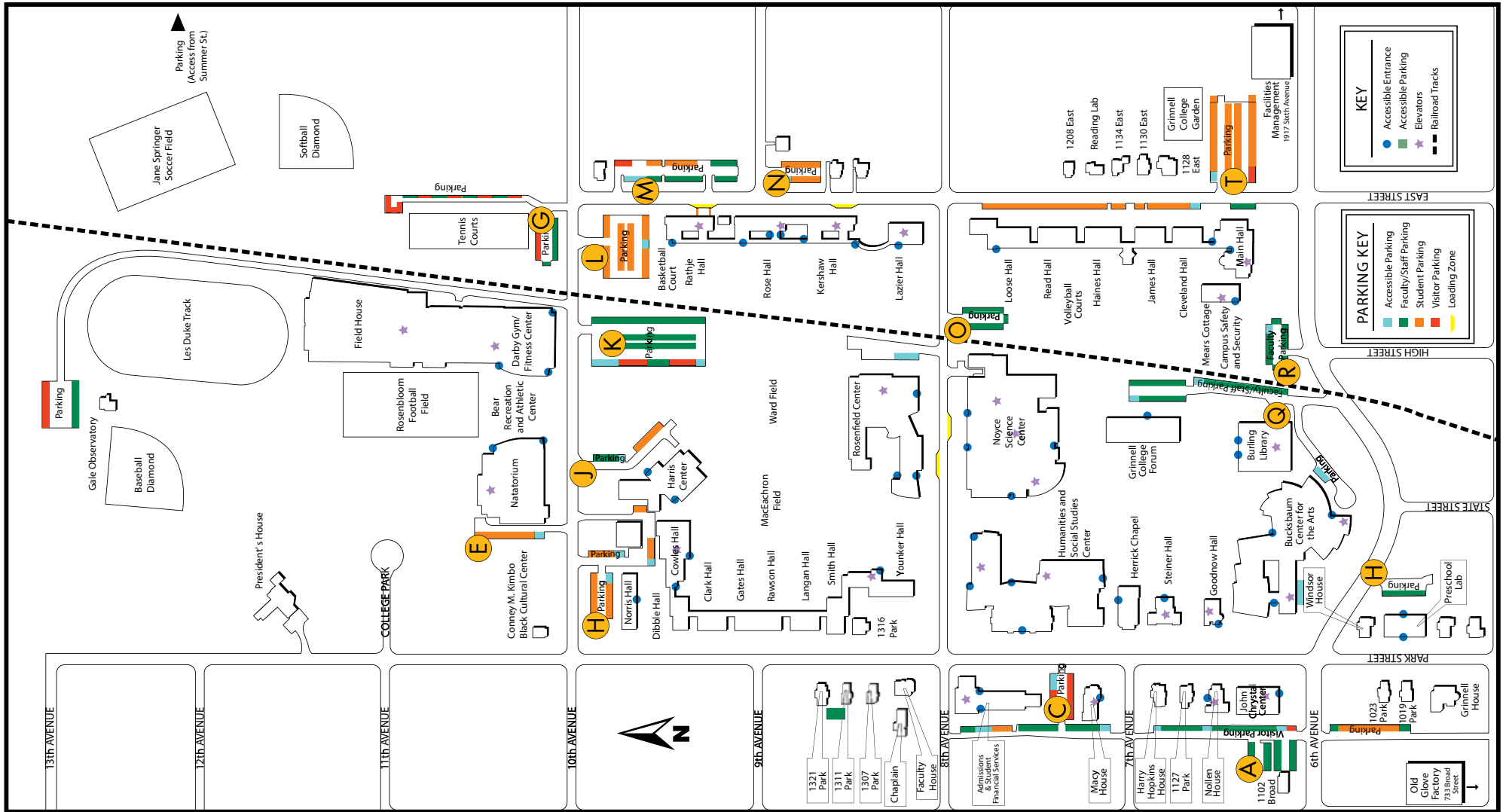

Please scan the QR code to view a campus map.
grinnell.edu/map

Use of this QR code is subject to the user's acceptance of the uQR.me privacy policy found at <https://uqr.me/privacy>.

5:30–7:30 p.m.

Shabbat Service and Table

JRC, Room 209

A short Sabbath blessing will be led by Harold Kasimow, professor emeritus of religious studies. The service will begin at 5:45 p.m. followed by a kosher-style meal. This is a ticketed meal.

6–8:30 p.m.

60th Reunion Class Dinner

HSSC, A1231 (multipurpose room)

A special celebratory dinner for the classes of 1961 and 1962.

6:30–10 p.m.

55th Reunion Class Dinner

Grinnell Golf Course, banquet room and lounge, 933 13th Ave.

A special celebratory dinner for the classes of 1965 and 1966. Dinner will end around 8 p.m. with music to follow.

8–10 p.m.

Too Many Strings Band

Main Hall, Bob's Underground

Enjoy acoustic folk and bluegrass music performed by some of your favorite Grinnell professors. **This is a substance-free event.**

8:30 p.m.–midnight

50th Reunion Social (1970, 1971, and 1972)

Harris Center, concert hall

Featuring the music of I-398.

25th Reunion Social (1997)

Haines Hall, tent and lounge

45th Reunion Social (1975, 1976, and 1977)

Yunker Hall, tent and lounge

9 p.m.—midnight

35th Reunion Social (1986, 1987, and 1988)

Central Campus, commencement stage

Featuring the music of She Man and the Masters of the Universe.

20th Reunion Social (2000, 2001, and 2002)

Mac Field

10–11:30 p.m.

Grant O. Gale Observatory open hours

College Observatory

Professor Bob Cadmus will show you the stars. Shuttles will depart from the JRC parking lot approximately every half hour. Or feel free to walk out to the Observatory. Last shuttle will depart at 11 p.m.

Midnight

Bakery Run 2.0

Meet at the steps of Herrick Chapel to head to Grin City Bakery, 934 Main St.

Revisit an old tradition at the new bakery. Grin City Bakery will serve some familiar favorites and some new, soon-to-be favorites, too.

SATURDAY, JUNE 4

6–9:30 a.m.

Birding Excursion

Departs from the Southeast entrance of the JRC

Hosted and led by **Jeri Langham '65**, tour leader for Victor Emanuel

Nature Tours, offering birding excursions worldwide. Bring your binoculars (a limited number will be available to borrow). Space is limited. Please sign up at the Reunion Registration area. Sponsored by the classes of 1965-66.

7–9 a.m.

Breakfast in the Marketplace

JRC, Marketplace

7:30–9 a.m.

Alumni Fun Run/Walk

Starting line: south side of Charles Benson Bear '39 Recreation and Athletic Center

A tradition for more than 20 years, the Alumni Fun Run/Walk is a great way to start your Reunion Saturday. In case of inclement weather, this event will be canceled.

8–10:30 a.m.

Trip to Conard Environmental Research Area (CERA)

Departs from front of JRC

Join faculty from the Department of Biology in touring the College's biological field station. The one-mile hike will take you through reconstructed prairie, restored savanna and through two experimental plot arrays, ending with a brief tour of the Environmental Education Center. Space is limited. Please sign up at the Reunion registration area.

9–10:30 a.m.

President's Reception (for volunteers and leadership donors)

Grinnell House Lawn, 1011 Park St.

This reception, for Reunion volunteers and leadership donors, is by invitation only.

9–10 a.m.

Grinnell College Campus Tour

Departs from JRC, mailroom

9:30 a.m.

Serenity Sisterhood – Women's AA/Al-Anon Recovery Meeting

St. Paul's Episcopal Church, 1206 State St.

All women are welcome to this recovery meeting held off campus, just across Sixth Street.

9:30–10:30 a.m.

An Open Grinnell College Christian Fellowship Reunion

Central Campus, 50th Reunion tent

This is open to anyone who participated in the Grinnell College Christian Fellowship REGARDLESS of where you are now in your spiritual journey. Whether you have substantially the same beliefs as you did at college or have changed your perspective, this time is for you to connect with people who were part of that intimate journey of sharing during your college years. Hosted by **Art Andrews '70**.

10:45 a.m.–12:15 p.m.

**Liberal Arts in Prison Program:
Panel Discussion**

JRC, Room 101

In keeping with Grinnell's mission and core values, the Liberal Arts in Prison Program provides liberal arts education at a local prison and a juvenile detention center. Five years ago, the program inaugurated its First Year of College Program, which brings for-credit Grinnell courses to incarcerated students at Newton Correctional Facility. Join former incarcerated students, program director **Emily Guenther '07**, and faculty members for a panel discussion about the program's impact.

10 a.m.–noon

Grinnell Farmers' Market

Central Park, Fourth Avenue and Broad Street

This market is a 100% producers' market; all vendors must sell products that they produce themselves.

10:30 a.m.–noon

Pickup Basketball

Bear Athletic Center, auxiliary practice gym

Get your June Madness on with some coed pickup basketball with your '86, '87, and '88 cluster mates! Half-court play. We'll provide the balls and towels; you bring sneakers and water.

11 a.m.–noon

**THANKS A LOT! Mark
Anderson '77, monologue**

Bucksbaum, Room 154 (Wall Theatre Lab)

In THANKS A LOT! **Mark**

Anderson '77 expresses gratitude and vents a little about the ups and downs of the past two years. Oh, and he talks about Chekhov. And geese. Sponsored by the classes of 1975, 1976, and 1977.

11 a.m.

**The Great Grinnell Campus
Scavenger Hunt**

JRC, information desk

How well do you know your campus? Search campus for locations and information in this scavenger hunt. Form a team with friends or bring your family! Anyone can participate. There are two difficulty levels, one for young children and one for adults. Stop by the information desk in the JRC and pick up the details.

11 a.m.–noon

**Tour the New Humanities and
Social Studies Center (HSSC)**

HSSC, courtyard

11 a.m.–2 p.m.

Crowdsourcing Photos

JRC lobby

Help the Burling Library Special Collections and Archives staff identify photographs from your time at Grinnell. Staff from the Special Collections and Archives will host a table in the JRC lobby, asking alumni to help identify people, places, and events found in our photograph collection. We will have photos available from every class or cluster at Reunion, so please stop by and lend a hand!

11:30 a.m.–1:30 p.m.

Lunch in the Marketplace

JRC, Marketplace

Class Photo Schedule

Bear Athletic Center, Darby Gym

10:30 a.m. — 1997

10:40 a.m. — 1961

11 a.m. — 1962

11:20 a.m. — 2000

11:40 a.m. — 2001

Noon — 2002

12:20 p.m. — 1986

12:40 p.m. — 1987

1 p.m. — 1988

2:20 p.m. — 1975

2:40 p.m. — 1976

3 p.m. — 1977

3:20 p.m. — 1965

3:40 p.m. — 1966

12:15–1 p.m.

Titular Head Screening

HSSC, S1325 (Presentation Room)

Join the classes of 2000, 2001, 2002 for a Best of Titular Head screening featuring short films from the late 1990s to early 2000s.

1–1:45 p.m.

Leaving a Legacy

HSSC, C1425 (Max Teisinger '76 reading rooms)

Celebrate this legacy gift to Grinnell by visiting the Max Teisinger '76 reading rooms in the Reading, Writing, and Speaking Center in honor of the class of 1976. Hear from faculty about how the space is being used, and learn more about how you can leave a legacy to make a difference for students of today

and tomorrow. A toast to celebrate this new space will take place at 1:30 p.m. Time will be provided at the end of the event to meet some of Grinnell's development officers and ask any questions you might have about your own philanthropic plans. Sponsored by the class of 1976.

1–2 p.m.

Grinnell College Campus Tour

Departs from JRC, mailroom

1–2:30 p.m.

**The Arc of the Grinnell Attitude
in Our Lives**

Meet in the HSSC atrium

**This event is exclusively for
the 50th Reunion Cluster.**

Many of us remember Martin Luther King's address to the Grinnell community that spoke to social justice, engagement with things that matter, the interconnectedness of life, and the courage to make a difference. It included King's memorable passage that "the arc of the moral universe is long, but it bends toward justice." That speech connected at a broad level with the "attitude" that legendary Grinnell president John H. T. Main believed went hand-in-hand with the Grinnell education — a sensibility to go into the world to lead active, curious, and purposeful lives. How has the Grinnell sensibility played out in your life? Join fellow 50th Reunion classmates for a special discussion of these topics. Meet in the HSSC atrium to draw an assignment for your room.

1–3:30 p.m.

Mac Field Chill Time

Mac Field

Celebrate your Reunion by doing nothing! The 20th and 25th Reunion groups will hang out on Mac Field with some yard games and plenty of time to reminisce and (hopefully) soak in the sun. Bring your picnic blankets and bag chairs! Sponsored by the classes of 1997, 2000, 2001, and 2002.

2–3 p.m.

Grinnell Preschool Open House

*Grinnell College Preschool Lab,
1022 Park St.*

2–3:30 p.m.

Class of 1961 – Remembering Our Classmates

JRC, Laurel Leaf Lounge

Join members from the class of 1961 to reminisce and reflect on the years gone by, especially classmates who are no longer with us.

2:30–4 p.m.

Storytelling: Turning Points

Main Hall, Bob's Underground
GC Moth Hour-like program on the theme "Turning Points." Small, large, funny, poignant — storytelling of moments that became turning points. Sponsored by the classes of 1986, 1987, and 1988.

3–4 p.m.

Open Rehearsal

Bucksbaum, Room 104 (Sebring Lewis Hall)

Rehearsal performance featuring music by Piazzolla, Bach, and Mozart. Performers include **Dan**

Frohardt-Lane '70, Tim Perry '70, Kathy Schaff Broadwell '70, David Broadwell '71, and Carol Schmidlein Margolis '71.

All are welcome to come and listen. Sponsored by the classes of 1970, 1971, and 1972.

4:30–5:45 p.m.

Alumni Assembly, Featuring the Presentation of the 2022 Alumni Awards

Herrick Chapel

The premier event of the weekend. All alumni are encouraged to attend. This event will also be livestreamed at grinnell.edu/livestream.

6–8 p.m.

All Reunion BBQ Dinner

Eighth Avenue

Join all Reunion attendees for a BBQ dinner! In case of inclement weather, this event will be moved inside to the Marketplace, and classes will be assigned specific times in order to allow seating for all. We appreciate your cooperation with a rain plan if it is necessary. Meal ticket required.

7–8:30 p.m.

Night at the Museum: A Look Behind the Scenes

Bucksbaum, Room 131 (Grinnell College Museum of Art)

An exclusive, intimate look behind the exhibitions at the Grinnell College Museum of Art; from new exhibit designs to curriculum integration. Learn about the extensive research, innovative teaching, and creative engagement within its walls. After, join in the rotunda for

light refreshments and continued conversation with museum staff.

7:30–8:30 p.m.

One of a Kind, Ahead of Her Time: Appreciating the Unique Entertainment Georgia Dentel Brought to Grinnell College

Smith Hall, Lounge

Join classmates for casual reminiscing and celebrating our good fortune to enjoy so many talented, cutting-edge, and classic performances and films during our years at Grinnell. Sponsored by the classes of 1975, 1976, and 1977.

7:30–10 p.m.

60th Reunion Social

Home of Nancy Schmulbach Maly '61, 15504 Jacob Ave., Grinnell

Transportation will be provided. Pickup from the driveway just east of the JRC.

7:30–10 p.m.

55th Reunion Social

Grinnell Golf Course, banquet room and lounge, 933 13th Ave.

8–9 p.m.

Open AA/Al-Anon Recovery Meeting

Goodnow, Room 109

Alumni, their families, staff, and students are welcome to attend.

8:30 p.m.–midnight

50th Reunion Party with I-398

Harris Center, concert hall

9 p.m.–midnight

45th Reunion Party with Loggia Patrol

Main Hall, Gardner Lounge

9 p.m.–1 a.m.

Reunion Dance Party

HSSC, Kington Plaza

Come dance the night away with our Reunion DJ. In case of inclement weather, this event will move to the HSSC Atrium.

9:30–11 p.m.

Grant O. Gale Observatory Open Hours

College Observatory

Professor Bob Cadmus will show you the stars. Shuttles will depart from the JRC parking lot approximately every half hour.

SUNDAY, JUNE 5

8:30–11 a.m.

Farewell Breakfast

JRC, Marketplace

End the weekend right. This is the perfect setting to say goodbye before heading home. If you must leave campus before 8:30 a.m., you may exchange your Sunday breakfast meal ticket for an assortment of breakfast items at the Spencer Grill.

9–10 a.m.

Interdenominational Christian Worship Service

Herrick Chapel

Join the service led by the **Rev. Ed Zellej '88**. Service organized by the Rev. Deanna Shorb and the Center for Religion, Spirituality, and Social Justice.

1:30 p.m.

Residence Halls Close

GENERAL INFORMATION

Emergency and Non-Emergency Assistance

For emergency, 24-hour assistance, please call the Office of Campus Safety, 641-269-4600.

The Reunion help desk

(641-269-4801) is "Reunion central" on campus and can assist you with all non-emergency matters.

Meal Reservations

If you are preregistered, your meal tickets for each meal are included in your name badge. A limited number of extra meals are available for purchase at the Reunion help desk in the JRC,

across from Spencer Grill. Stop by to purchase a ticket, or call the help desk (641-269-3223) to inquire about availability.

Keys and Key Cards

Please keep both your key and your P-card in the envelopes in which they came and return both in their envelopes at the end of Reunion weekend. Boxes for the return of keys and key cards are at the registration desk. There is a fine for non-returned items.



Conard Environmental Research Area (CERA) and Environmental Education Center

OPEN HOURS

Center for Religion, Spirituality, and Social Justice (CRSSJ)

The multireligious meditation and prayer space is available for your use during Reunion weekend.

Hours:

8 a.m.–11 p.m. Friday and Saturday
8 a.m.–noon Sunday

Conard Environmental Research Area (CERA) and Environmental Education Center

Wednesday–Sunday: 9 a.m.–5 p.m.

Admission and Student Financial Services Center

Wednesday–Friday: 8 a.m.–5 p.m.

Charles Benson Bear '39 Recreation and Athletic Center

Includes the indoor track, racquetball courts, gymnasiums, indoor tennis courts, bouldering wall, and shower facilities. Alumni need to present their Reunion nametags for entrance.
Thursday–Saturday 6 a.m.–7 p.m.
Sunday 7 a.m.–noon

Fitness Center

Thursday–Saturday
6–10 a.m.
11 a.m.–2 p.m.
4–6:30 p.m.
Sunday
7–10 a.m.

Climbing Wall

Experienced or newbie rock climbers welcome. Belayer will be present for safety and for informal lessons on climbing.

Friday 1–5 p.m.
Saturday 9 a.m.–noon

Russell K. Osgood Pool

Due to unexpected maintenance issues, the Osgood Pool will not be open during Reunion Weekend.

The Grinnell Mutual Family Aquatic Center is at 120 Eighth Avenue West and opens for the season on Friday, June 3. Lap swimming is available 7–9 a.m. Saturday. Open swimming is noon–6 p.m. Friday, noon–7 p.m. Saturday and Sunday.

OTHER CAMPUS HOURS

Pioneer Bookshop

933 Main St.

Thursday 8:30 a.m.–7 p.m.
(Alumni Author Reception 5–7 p.m.)
Friday 8:30 a.m.–5 p.m.
Saturday 9 a.m.–4 p.m.
Sunday 10 a.m.–1 p.m.

The Spencer Grill

Wednesday 11 a.m.–4 p.m.
Thursday 8 a.m.–7 p.m.
Friday 6 a.m.–5 p.m.
Saturday 6 a.m.–4 p.m.
Sunday 6 a.m.–noon

Burling Library

Thursday 8 a.m.–5 p.m.
Friday 8 a.m.–7 p.m.
Saturday 9 a.m.–5 p.m.
Sunday 11 a.m.–4 p.m.

Kistle Science Library

Thursday, Friday 9 a.m.–4 p.m.
Saturday 9 a.m.–4 p.m.
Sunday Closed

Special Collections

Thursday, Friday 1:30–5 p.m.
Saturday, Sunday Closed

ART EXHIBITIONS

GRINNELL COLLEGE MUSEUM OF ART

(includes Faulconer Gallery)
Bucksbaum Center for the Arts

Thursday, Friday 11 a.m.–5:30 p.m.
Saturday Noon–5 p.m.
Sunday Closed

Current Exhibition

Sustaining Vision: Recent Gifts and Purchases for the Museum of Art Collection.

The art collection of Grinnell College has been growing since the institution's early days. The uncertainty of the past three years has had little impact on this expanding diversity and growth. In the visual arts, as in the human creative impulses at their heart and in the heart of every Grinnellian, the supply chain is not an issue.

In honor of the classes of 2020, 2021, and 2022, and in embrace of the many classes of faithful and generous alumni returning this summer for long-delayed reunions, we are proud to present this exhibition of the most recent additions to our collection.

Join Us for A Night at the Museum!

Join us on Saturday, June 4, from 7 to 8:30 p.m., for an exclusive, intimate look behind the exhibitions at the Grinnell College Museum of Art, from new exhibit designs to curriculum integration. Learn about the extensive research, innovative teaching, and creative engagement within its walls. Then enjoy light refreshments and continued conversation with museum staff in the rotunda.



Falconer Gallery

REUNION CLASS VOLUNTEERS

1961:

Nancy Welch Barnby
Hunt Davis, class fund director
Joel Goldstein
Duane Krohnke
Nancy Schmulbach
Maly, class agent
Jack Swenson, class fund director

1962:

Ann Hamilton
Campbell
Bill McKnight, class fund director
Bob Musser, class agent
Ron Sandler
Linda Miller Staubitz
Gof Thomson, class fund director

1965:

David May, class fund director
Donn McLaughlin
Barbara Hunt
Moore, class agent
Becky Reetz Neal

1966:

Ruth Koehler
Bergerson, class agent
Laurie Houdek Hill, class fund director
Jim Holbrook, class fund director
David Miller

1970:

Jon Andelson
Kathy Schaff
Broadwell

Nora Sansone

Hoover, class agent
Cindy Maier
Chris Meyer, class fund director
Bruce Nissen
Merryll Penson
Michael Penzner
Roger Roe
Phyllis Shannon
Salyards
Tom Thomas

1971:

Mary Brooner, class fund director
Mark Hamilton
Katherine
Sutherland
Hauser
Andrew Hauser
Alex Karlin
Becky Davis
Kemmerer
JC Labowitz, class agent
Susan Holden
McCurry
John Otto
Patti Rounsevell
Ken Schofield
Anne Taylor
Schwaller, class fund director

1972:

Mary Kay Kasang
Allen
Chris Anderson
Mario Bognanno
Alan Cohen
Mike Daley, class fund director
Mitch Erickson
Shelley Floyd

Greg Gaines

David Hechler, class agent
Chuck McGrath
Celia Millington-Wyckoff
Nancy Mills
Linda Pinsker
Barbara Leslie
Putney
Lynne Siemers
Gary Spencer
Greg Thielmann
Kim Thomas
Marty Wice

1975:

Ellen Bouma Barnes
David Calvert, class fund director
Jim Decker, class fund director
Bill Ferguson
John Hinde
Craig Hobbs
Cady Landa
Cheryl Pickard
Maura Zwerling
Weitzman
Betsy Wolcott, class agent

1976:

Margaret Bogie, class agent
Janey Brunton-Munoz
Julie Dunn
Christine Davidson
Jensen
Austin Kessler
Kate Kramer
Michael Nadalsky
Robert Ruhl, class fund director

REUNION CLASS VOLUNTEERS

David Stein, class fund director

1977:

John Aubry, class fund director

Claudia Beckwith

Tim Hopkins

Sharla Fishhaut Levine

Ruth Montgomery

Carter Newton, class agent

Robert Render

Kit Wall

1986:

Susan Rest Asplund

Dave Cameron

Todd Fox

Andrew Hopson

Patrick Kasperitis

Roberta Saielli Lewis

Ruth Marner

Daniel McGrath

Christopher

McKeachie, class fund director

Terri Porter

Robert Quashie

Rebecca Quirk

Philip Shiffman, class fund director

Rhonda Stuart, class agent

1987:

Daniel Baskes, class fund director

Tim Black

Sam Potter Bloom, class agent

Kate Chang

Danielle Currier, class fund director

Jane Davidson

Pam Feinstein

Alexandra Hoffman

Gottdiener

Alison Hayes

Sarah Jolie, class agent

Peggy Nelson

Byron Ricks

Deb Saeger

1988:

Tommie Adams

Jim Asplund

Paula Rue Dillon

Lisa Grant

Eric Johnson

Mark Schumann,

class fund director

Jeff Skelton, class fund director

Jennifer Sultz, class

agent

Ed Zelley

1997:

Lisa Alexander

Sean Cotten

Celia Davis

Shannon Chipman

Heers

Jackie MacNeish

Karmi Mattson

Sara Nesler, class

agent

Sarah Piltch

Tina Popson

Sara Shives

Kirpal Singh, class

fund director

Nancy Taylor

Alex Wood

2000:

Lue Schutzman

Bowen

Juan Castaño

Sarah Conner

Flinders, class fund director

Deana Greenfield

Skye Langs, class fund director

Indhira Lapuma, class agent

Corey McIntosh

Julian Zebot

2001:

Ivy Chang

Abby Copeman

Petig

Jon Pettitt, class fund director

Roshan Shrestha,

class agent

Aaron Stockham

Sherman Willis, class

agent

2002:

George Carroll, class fund director

Erika Dowd

Phillip Hales

Nicholas Johnson

Ross Ricenbaw

Abbey Scheckter,

class fund director



Join Us at a Grinnell College Summer Picnic!

Continue the Grinnellian fun after Reunion — summer picnics return this year in 31 cities across the country!

Summer picnics are fun, casual get-togethers for Grinnellians. They are hosted by fellow Grinnell alumni and friends, along with the Office of Development and Alumni Relations. All members of the Grinnell Community — alumni, current students, incoming new students, family members, and friends — are welcome at summer picnics.

Every picnic is a bit different, but at every picnic you will find great food, meet new friends, and connect with Grinnellians from your area.

Find your best summer picnic location at alumni.grinnell.edu/events/summer-picnics.

Questions? Contact **Ashley Renstrom-Schaefer**, associate director of alumni and donor relations, at schaefer@grinnell.edu or call **641-269-9317**.

